

ANTHONY JAMES MANSEY

Residential Sales & Lettings



Lismore Close

Isleworth, TW7 6QX

£365,000

Leasehold

Council Tax Band

Situated in a quiet cul de sac off Linkfield Road. A ground floor purpose built maisonette comprising an entrance hallway, spacious reception room, two double bedrooms and bathroom. This property benefits from central heating. Externally there is a private garden for you to enjoy long summer days. Isleworth town provides an excellent variety of local shops and the station serves Waterloo. The H37 hopper bus regularly takes you to St Margaret's and Richmond.

This property will come with a lease of approximately 124 years.

Viewing

Please contact our Sales Office on 020 8847 0488 if you wish to arrange a viewing appointment for this property or require further information.

- A ground floor purpose built maisonette
- Spacious reception room
- Two double bedrooms
- Double glazed windows
- Private rear garden
- Chain free vacant possession
- Short walk to St Johns Gardens
- Isleworth Station serving Waterloo
- Keys available to view now



Floor Plan

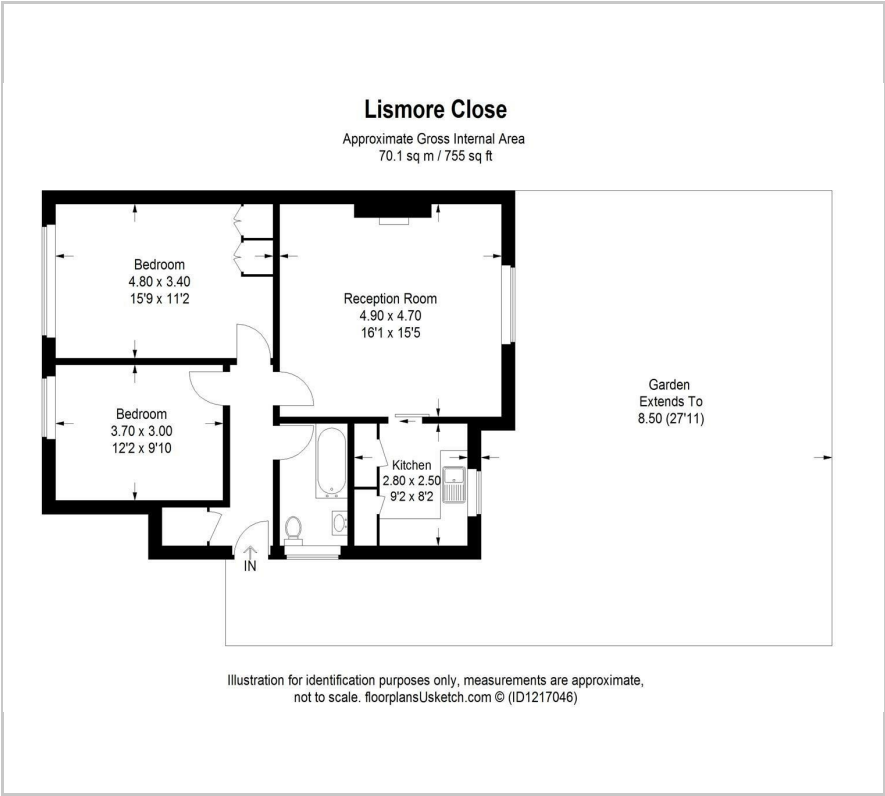

Area Map

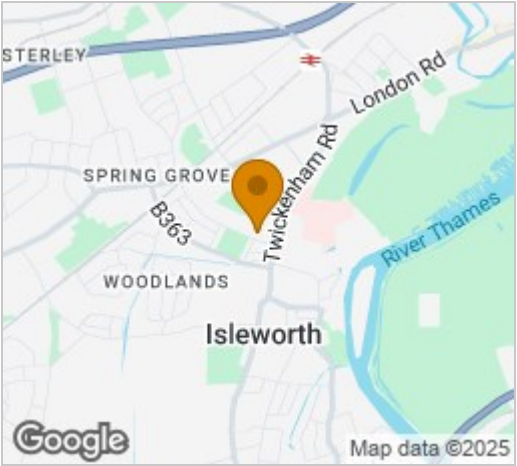

Energy Efficiency Graph

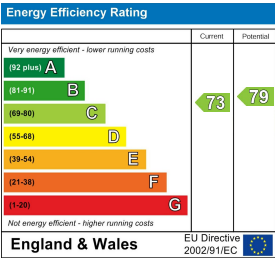

These particulars, whilst believed to be accurate are set out as a general outline only for guidance and do not constitute any part of an offer or contract. Intending purchasers should not rely on them as statements of representation of fact, but must satisfy themselves by inspection or otherwise as to their accuracy. No person in this firms employment has the authority to make or give any representation or warranty in respect of the property.